

# PLAT OF SURVEY

OWNER: MILLENNIUM DEVELOPMENT  
PARTNERS II, LLC.  
BUILDER: QUANTUM ENTERPRISES, LLC  
N47 W27 585 LYNNDAL RD  
PEWAUKEE, WISCONSIN 53072

BUILDING 6 OF THE FIELDS OF DELAVAN, BEING A REDIVISION OF LOT 1  
OF CERTIFIED SURVEY MAP NO. 2577, BEING PART OF THE SOUTHWEST  
QUARTER (SW 1/4) OF SECTION 13, TOWN 2 NORTH, RANGE 15 EAST  
CITY OF DELAVAN, WALWORTH COUNTY, WISCONSIN.

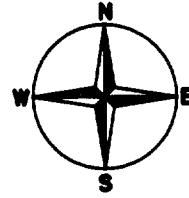

EXISTING GARAGE ELEVATION: 949.60

REFERENCE BEARING: ALL BEARINGS ARE REFERENCED TO GRID NORTH OF THE WISCONSIN STATE PLANE COORDINATE  
SYSTEM SOUTH ZONE.

## BIRCHWOOD STREET

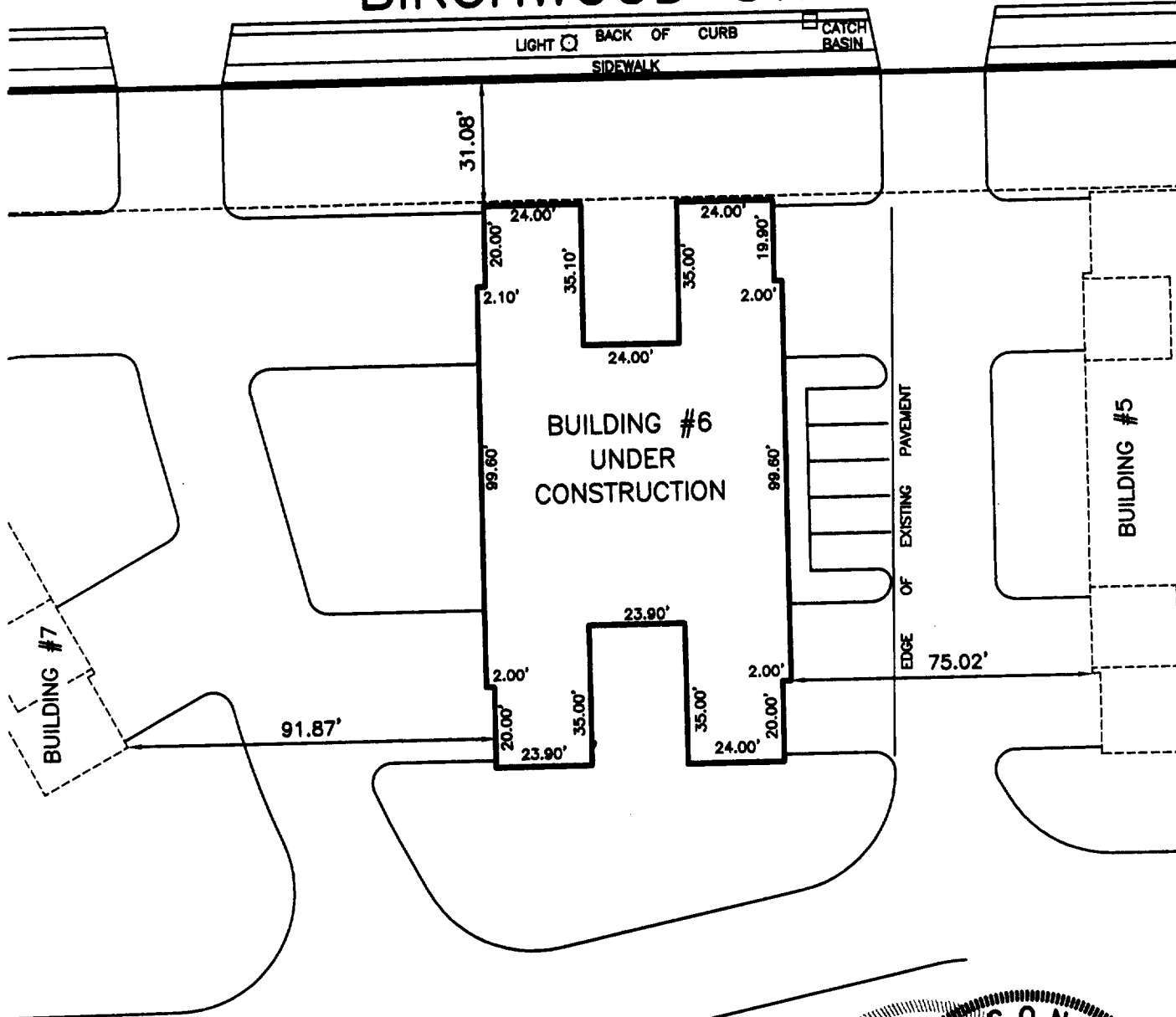

PLAN DATED: JANUARY 22, 2002  
FILE NO.: D:\0100\01123  
PLAN SCALE: 1" = 40'

MAY 23 2003

STATE OF WISCONSIN }  
COUNTY OF JEFFERSON } SS.

WE, PIONEER ENGINEERING & SURVEYING, DO HEREBY CERTIFY THAT WE HAVE MADE THIS SURVEY AND THAT  
THE INFORMATION AS SHOWN ON THE ABOVE PLAT OF SURVEY IS TRUE AND CORRECT REPRESENTATION THEREOF.

### PIONEER ENGINEERING AND SURVEYING, LLC.

CONSULTANTS IN SUBDIVISIONS  
AND COMMERCIAL DEVELOPMENTS

3902 C.T.H. "B"

JOHNSON CREEK, WI. 53038

(920) 699 - 3330 FAX: 699 - 3332

